

Reverse Osmosis System

Replacing your RO Membrane

PLEASE READ THIS MANUAL CAREFULLY BEFORE SERVICING

Diagram 1 - Labelled Assembly of Quality Components

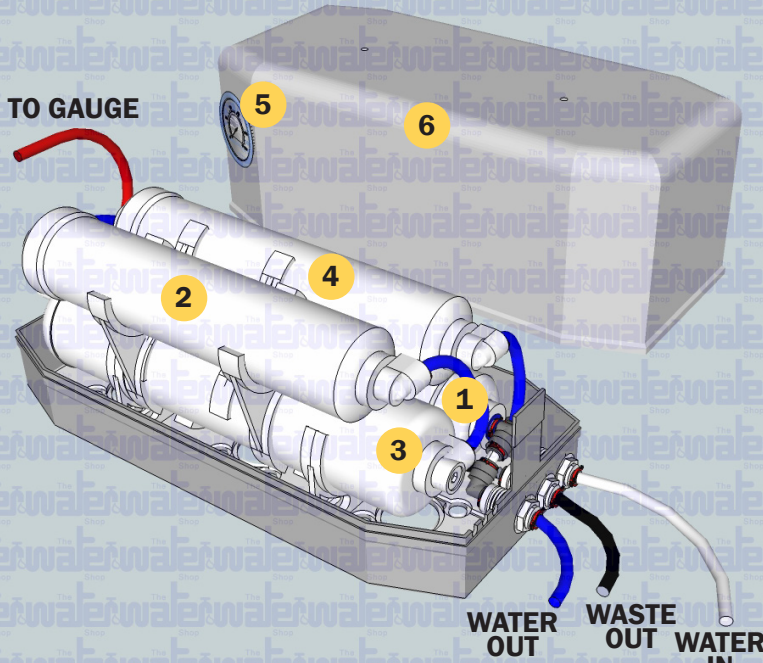
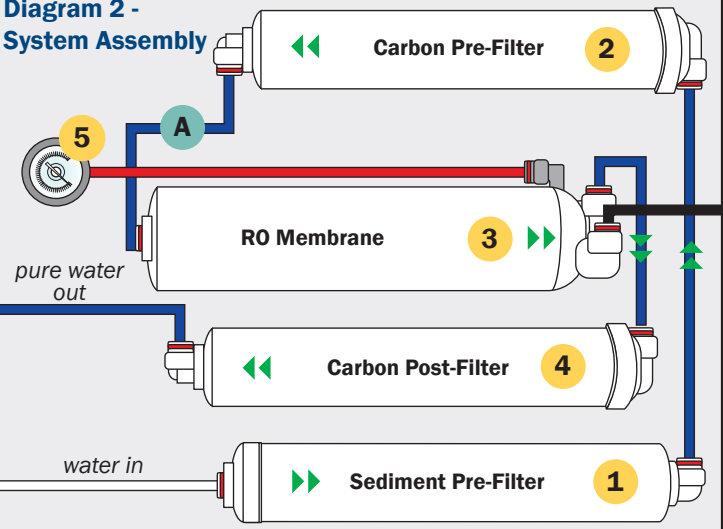

Diagram 2 - System Assembly



Components

- | | | | |
|---|---------------------|---|--------------------|
| 1 | Sediment Pre-Filter | 4 | Carbon Post Filter |
| 2 | Carbon Pre-Filter | 5 | Pressure Gauge |
| 3 | RO Membrane | 6 | Plastic Cover |

Diagram 3 - Tube Connections

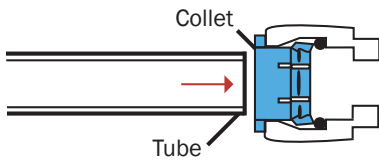

1 To make the connection, push the tube firmly into the connector.

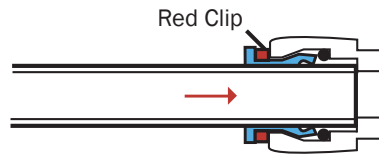

2 Make sure the tube is pushed as far as it can go and secure with a John Guest red clip.

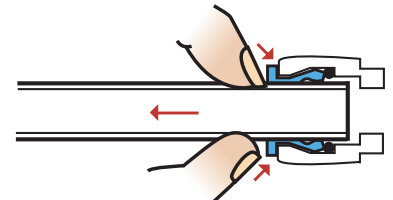

3 To remove the tube - first, remove the red clip and then use two fingers to push onto the collet and at the same time pull out the tube.

IMPORTANT: Turn off the the water supply before beginning to service the filter.

1 Disconnect the tubing A from the inlet of of RO Membrane (see **Diagram 2**).

NOTE: The housing will contain water, it is recommended to have a towel and/or small bucket at hand.



2 Unscrew and remove the housing cap 2 using the spanner 3 provided, turning in an anti-clockwise direction.

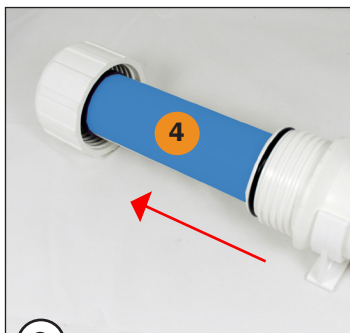

3 Remove the used RO Membrane 4 from the housing sump and dispose of responsibly.

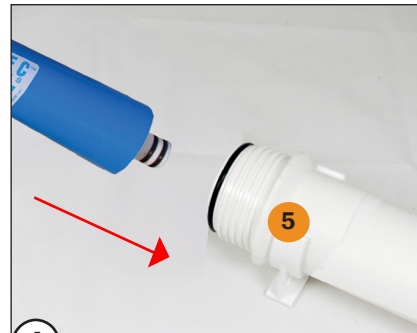

4 **Installing Your New Cartridge:** Insert the double O-Ringed end of the new RO Membrane into the housing sump 5

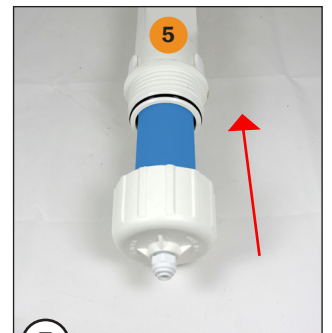

5 Insert into the housing. Screw on the housing cap using the spanner provided - do not overtighten, check for leaks.